

The Wellness Kitchen Cartridge Replacement Guide



Wellness Enterprises, LLC
418 SW 140th Terrace, Newberry, FL 32669
Phone: 352.333.0480 Fax: 352.333.0490
E-mail: support@wellnessfilter.com

Please check our web site for manual updates.
wellnessfilter.com/support/downloads/



Wellness Kitchen Cartridge Replacement Instructions

Congratulations on your purchase of a replacement cartridge for your Wellness Kitchen. Each cartridge provides up to 1,200 gallons of filtered and enhanced water.

Please read the instructions below carefully before installing your cartridge to ensure proper system performance.

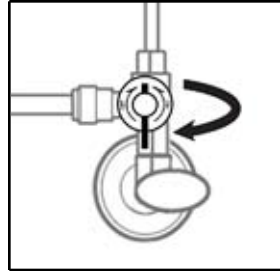

Undersink Only: Rotate angle-stop valve clockwise to the off position.

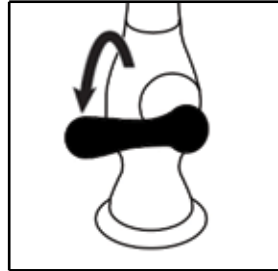

Undersink Only: Turn auxiliary faucet on to relieve pressure.

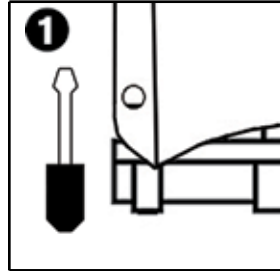

Remove 3 screw covers from unit. Remove screws with a coin or flathead screwdriver.

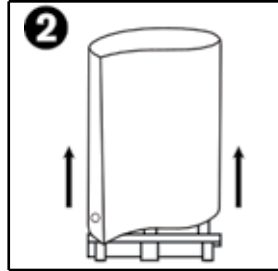

Pull case up and off base and set aside.

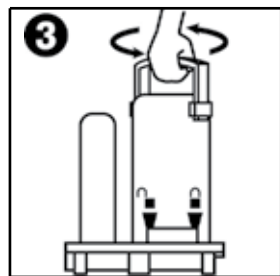

Pull cartridge handle up and rotate the cartridge counter-clockwise.

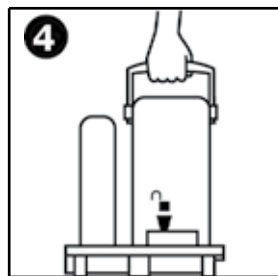

Stop when the arrow on the base lines up with the **unlock** symbol on the cartridge.

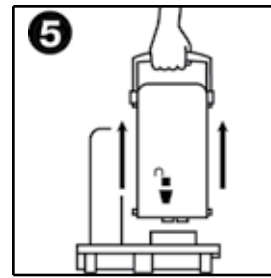

5 Pull handle to remove cartridge and set aside. Cartridge will drip.

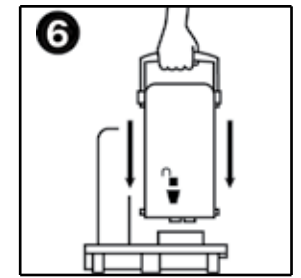

6 Remove cartridge caps and insert new cartridge into base with the unlock symbol and arrow aligned.

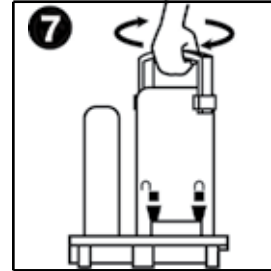

7 Rotate the cartridge clockwise until arrow on base lines up with **lock** symbol.

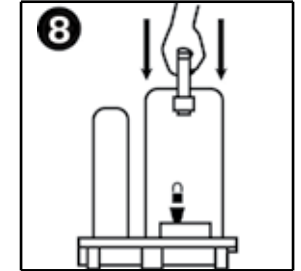

8 Press cartridge handle down.

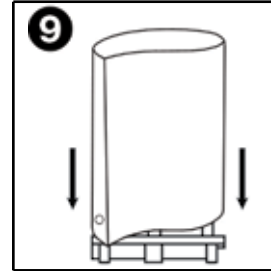

9 Place cover back over the base.

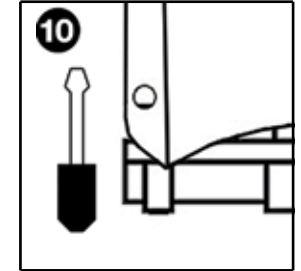

10 Secure base by screwing 3 screws back in. Replace screw covers.

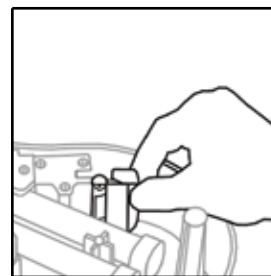

Changing the Batteries

1. Remove battery holder from base.
2. Remove AAA batteries and wait 30 seconds.
3. Install new AAA batteries (included in kit).
4. Insert battery holder into base.
5. Water droplet will flash Blue, Yellow, Red and a beep will sound. If this does not occur, check to ensure the batteries are inserted properly.

Congratulations! Your system is now ready for use. Run water for 2 minutes to flush carbon fines. If unit is installed under the sink, open shut-off valve.